

Service Corridor

21'-2"

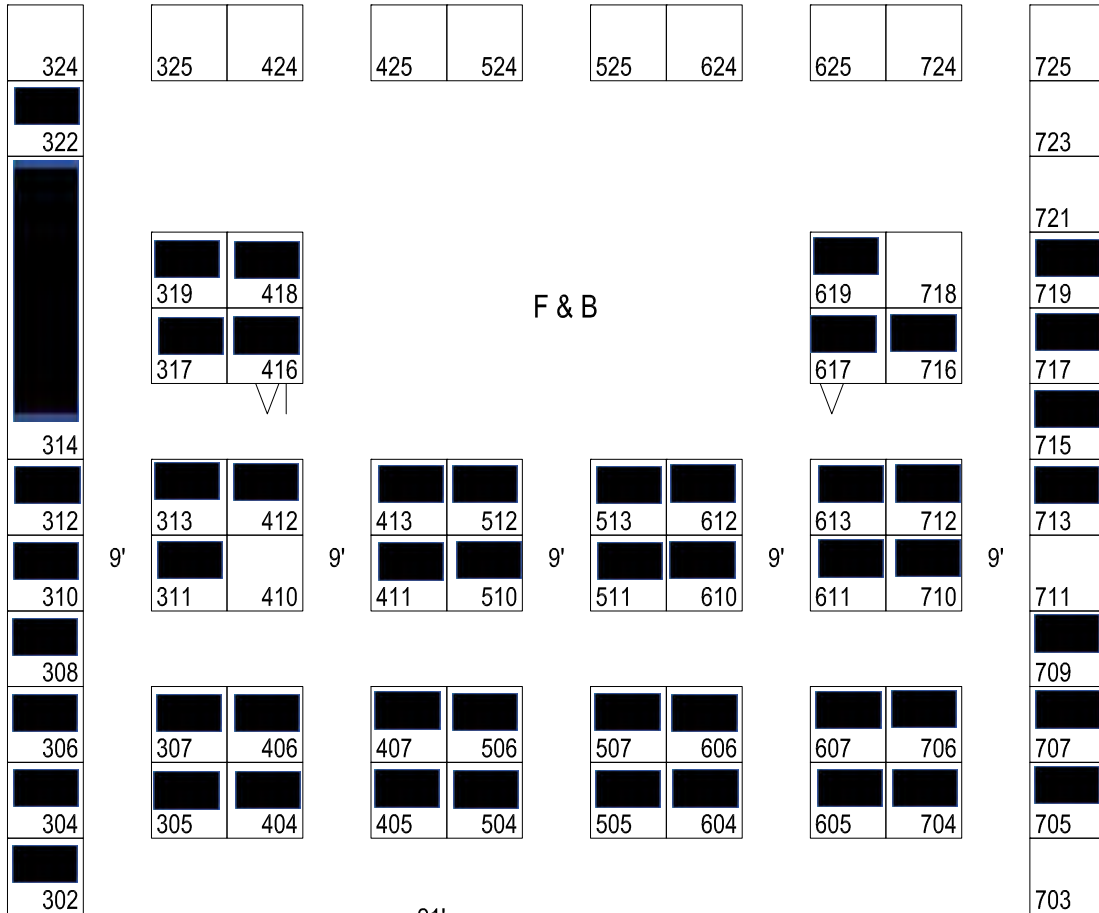

21'

# ENTRANCE

Prefunction

Staff Office

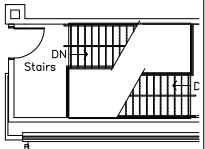

### Inventory

| Dimension      | Size | Qty       | SqFt         | Rented   | Available |
|----------------|------|-----------|--------------|----------|-----------|
| 10'x10'        | 100  | 68        | 6,800        | 0        | 68        |
| 10'x40'        | 400  | 1         | 400          | 0        | 1         |
| <b>Totals:</b> |      | <b>69</b> | <b>7,200</b> | <b>0</b> | <b>69</b> |



COPYRIGHT © BY GLOBAL EXPERIENCE SPECIALISTS. ALL RIGHTS RESERVED. NO PART OF THIS PUBLICATION MAY BE REPRODUCED, STORED IN ANY RETRIEVAL SYSTEM, OR TRANSMITTED IN ANY FORM OR BY ANY MEANS - ELECTRONIC, MECHANICAL, PHOTOCOPYING, RECORDING, OR OTHERWISE - WITHOUT EXPRESS WRITTEN CONSENT OF GLOBAL EXPERIENCE SPECIALISTS.

## SAEM 2018 Annual Meeting May 15-17, 2018

**JW Marriott Indianapolis Downtown - Grand Ballroom 5-6 - Level 3**

### CONFIDENTIAL PROPERTY OF GES

File: 0000-1000-marriott-indiana-100.dwg

Plot Date: May 04, 2017

By: AL2000

EVERY EFFORT HAS BEEN MADE TO INSURE THE ACCURACY OF ALL INFORMATION CONTAINED ON THIS FLOOR PLAN. HOWEVER, NO WARRANTIES, EITHER EXPRESSED OR IMPLIED, ARE MADE WITH RESPECT TO THIS FLOOR PLAN. IF THE LOCATION OF BUILDING COLUMNS, UTILITIES, OR OTHER ARCHITECTURAL COMPONENTS OF THE FACILITY IS A CONSIDERATION IN THE CONSTRUCTION OR USAGE OF AN EXHIBIT, IT IS THE SOLE RESPONSIBILITY OF THE EXHIBITOR TO PHYSICALLY INSPECT THE FACILITY TO VERIFY ALL DIMENSIONS AND LOCATIONS.